



The Moorings Fleet Expansion

2010-2011 Sailing Season

Fleet Investment

- Over \$65 million invested in new Moorings yachts this season alone
- Over 140 new yachts joining our global fleet
- 9 models being purchased, including two new models for 2010-2011 season

Fleet Investment

The Yachts	Distribution to Destinations		
Moorings 37.2	Tortola, BVI	Abacos	
Moorings 41.3	Tortola, BVI St. Lucia	Abacos Baja	Kos Lefkas
Moorings 43.3	Tortola, BVI St. Martin St. Lucia	Baja Athens	Kos Lefkas
Moorings 4600	Tortola, BVI St. Martin St. Lucia Abacos	Belize Agana Gocek Athens	Tahiti Thailand
Moorings 474 PC	Tortola, BVI	Abacos	
Moorings 372 PC	Tortola, BVI	Abacos	
ALL-NEW!! Moorings 50.5 (29 total)	Tortola, BVI – 13 yachts St. Lucia – 1 yachts St. Martin – 4 yachts Grenada – 3 yachts	Athens – 4 yachts Kos – 2 yachts Lefkas – 2 yachts	
Moorings 54.5	Tortola, BVI		

Moorings 50.5 Monohull



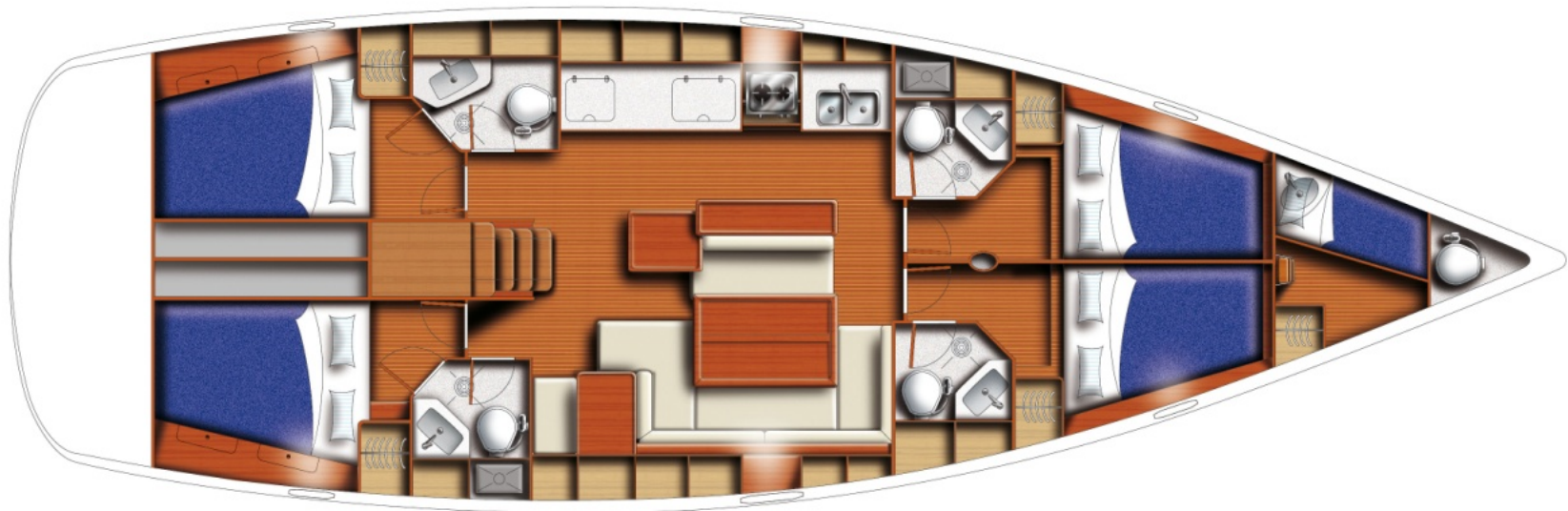

Moorings 50.5 - Yacht Plan

5-cabin / 5-head ~ Up to 11 Passengers

Designed for trade wind sailing with a deck that separates action from relaxation, she's relaxing, fun-to-sail and immersed in modern design, technology and style. This is the Beneteau 50 Family version.

M50.5 - Exterior

The Equipment

- Bow thruster
- Electric winches
- Electric windlass with remote control
- Full suite of upgraded Raymarine navigation electronics
- 9" color chartplotter with swivel base
- Cockpit-led sail controls
- Furling genoa, lazy jack & stack pack system
- 110hp Yanmar Diesel
- Air conditioning throughout
- Generator & Inverter (110v – Caribbean, 220v – Med)

On Deck Features

- Full bimini and dodger
- Expansive cockpit, foredeck and dual helm
- Sleek coachroof, long-side windows
- Fully-integrated mainsail arch with traveler
- Cockpit speakers



M50.5 - Interior

Saloon & Navigation Station

- Large U-shaped saloon
- Table converts to extra double berth
- Natural & indirect low-energy LED lighting
- VHF at chart table
- Flat screen TV/DVD, Radio/CD/MP3, interior speakers
- Ample headroom at 2m+

Galley (to Port)

- Excellent linear counter space & storage
- Stainless steel double sinks
- 3-burner gas stove + oven
- Microwave
- Refrigerator (130L) / Freezer (100L)
- Charcoal BBQ (on deck)

Accommodations

- 4 staterooms with en-suite electric head & hot/cold shower
- Forepeak berth with manual head & air conditioning



M50.5 - Destinations

Caribbean: *Sailing January 5, 2011*

- Tortola
- St. Lucia
- St. Martin
- Grenada

Charter Price Range: \$705 - \$1,335 per day

Mediterranean: *Sailing May 15, 2011*

- Athens
- Kos
- Lefkas

Charter Price Range: \$635 - \$1,315 per day

